

## WARNING BACKPACK GARDEN SPRAYER

Any piece of equipment can be dangerous if not operated properly. **YOU** are responsible for the safe operation of this equipment. The operator must carefully read and follow any warnings, safety signs and instructions provided with or located on the equipment. Do not remove, defeat, deface or render inoperable any of the safety devices or warnings on this equipment. If any safety devices or warnings have been removed, defeated, defaced, or rendered inoperable, **DO NOT USE THIS EQUIPMENT!!!**

 **WARNING:** This product can expose you to chemicals including lead, which are known to the State of California to cause cancer and birth defects or other reproductive harm. For more information go to [www.P65warnings.ca.gov](http://www.P65warnings.ca.gov)

If the person receiving this handout will not be the user of the equipment, forward these instructions to the operator. If there is any doubt as to the operation or safety of the equipment,

**DO NOT USE!!! CALL A TOOL SHED IMMEDIATELY!!!**

**FAILURE TO FOLLOW THESE INSTRUCTIONS COULD RESULT IN INJURY OR DEATH**

### WARNING

**WARNING: Improper use or failure to follow instructions can result in explosive failure causing serious eye or other injury.** For safe use of this product you must read and follow all instructions. Do not leave a pressurized sprayer in the hot sun. Heat can cause pressure build-up resulting in possible explosion. Do not store or leave solution in tank after use. Always wear goggles, gloves, long sleeve shirt, long pants and full foot protection when spraying. Never use any tool to remove pump if there is pressure in the pressure chamber. Never pressurize sprayer by any means other than the original pump. Do not attempt to modify this sprayer. Replace parts only with manufacturer's original parts. **Never spray flammable, caustic, acidic, chlorine, bleach or other corrosive solutions or heat, pressure, or gas producing chemicals.** Always read and follow chemical manufacturer's instructions before use with this sprayer as some chemicals may be hazardous when used with this sprayer.

**WARNING:** Handling the brass parts of this product will expose you to lead, a chemical known to the State of California to cause birth defects and other reproductive harm. *Wash hands after handling.*

### CAUTION

- **PRE-USE CHECK:** Before each use check tightness of hose nut to be sure hose is securely attached to the shut-off assembly. Insure hose is securely attached to the pump outlet by tightening hose nut. Insure that all nozzle and wand connections are tight. Insure the three bolts (underside of base) used to attach the piston cylinder are tight.

- Do Not exceed a tank solution temperature of 120° F.

**NOTE:** The tank and hose may have residual water in it due to quality testing performed on the sprayer.

### APPLICATIONS & USE FOR YOUR SPRAYER

Avoid using a sprayer for general cleaning purposes if plant protection or herbicide chemicals have already been used in the sprayer. If a sprayer has been used for plant protection or as an herbicide, clean the sprayer completely (see cleaning section) before using.

**Plant Food:** Use different spray patterns for optimum foliage feeding or for fungicide and pesticide application.

**Herbicides:** Reduce weeds and unwanted plants but avoid using the same sprayer for plant feeding or protection without thoroughly cleaning (see cleaning section) the sprayer first.

**General Household Use:** Apply detergents, cleaning solutions, warm water (do not exceed 120°F/49°C) or nontoxic household cleaning chemicals for carpets, floors, walls, glass, counter tops and ceilings. DO NOT use sprayer that has been used with herbicides, pesticides or other toxic chemicals for household applications.

**General Outdoor Use:** Use the sprayer for cleaning windows or with a detergent for general purpose cleaning.

**NOZZLE ASSEMBLY**

Figure 1-2

Unscrew the nozzle cap (1) from the nozzle body (3) with retaining nut (2) fastened tightly to the elbow (5). Unscrew the retaining nut (2). Push the nozzle body (3) with the nozzle gasket (4) out of the retaining nut (2). To reinstall the nozzle, reverse the above instructions.

Figure 3

Unscrew the retaining nut from the elbow and push the fan nozzle tip and gasket out of the retaining nut. To reinstall the nozzle, reverse the above instructions.

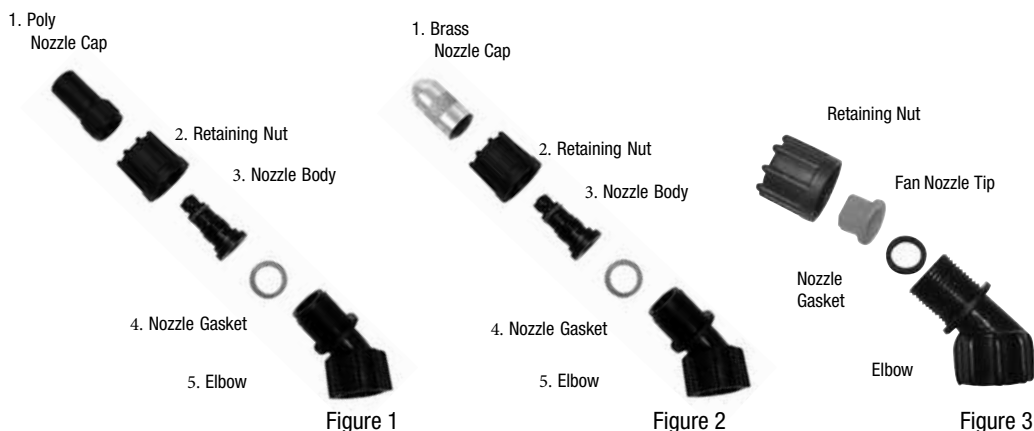

**SPRAYER COMPONENTS & USE INFORMATION**

**INSTALLING THE SHOULDER STRAP** The backpack strap is provided with multiple features including shoulder strap, chest strap, waist belt, lumbar support and back pad (figure 1). The top of both the shoulder strap and back pad strap are attached to the top of the tank and are removable. The back pad strap attaches to the bottom of the tank (figure 2).

The back pad is attached to its strap with Velcro and is removable ( figure 3).

The strap from the lumbar support attaches to the base of the sprayer by sliding buttons into the slot until they snap into place (Figure 4).

In the event that the sprayer harness (straps) become contaminated with chemicals, it is recommended to thoroughly wash the straps with soap & water and allow to dry before using the sprayer.



Figure 1  
Strap Assembly



Figure 2  
Back Pad Strap Attachment



Figure 3  
Removable Back Pad



Figure 4

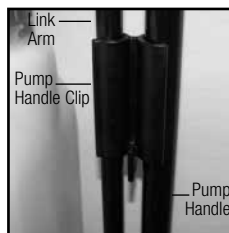

Figure 1

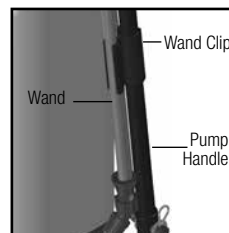

Figure 2

**WAND/PUMP HANDLE**

The pump handle stores vertically and sets into the pump handle clip (Figure 1). The wand is stored in the wand clip (Figure 2).

## FILLING THE SPRAYER

Make sure the filter basket is in place to keep debris from entering the tank. Determine the amount of mixture needed for your application. Add the proper amount of water to the tank. Add the proper amount of chemical to the tank (check the chemical label for proper ratio of chemical). Stir mixture in tank with a clean utensil (like a paint stirrer). The tank will hold the 5-gallon capacity plus the chemical.

It is not necessary to completely fill the sprayer tank with each use. You can fill the tank with only the amount needed for each application.

Always follow the manufacturer's instructions included on their product label.

## HELPFUL SPRAYING INFORMATION

Use RAPID pump strokes to prime the pump. You will know the pressure chamber is filling with liquid when you feel firm resistance from the pump handle. The air in the pressure chamber is compressed from repeated strokes. By pressing the hand lever on the shut-off, the valve opens. For safety lock-off feature (no-spraying), pull up on handle and move red locking mechanism into lock-off position as shown in fig. 1. To disengage, pull up on handle and return red locking mechanism to neutral position as in fig. 3. For lock-on feature (continuous spraying), push down on handle and move red locking mechanism into lock-on position as shown in fig. 2. To disengage, push down on handle and return red locking mechanism to neutral position as shown in fig. 3.

In the event that the handle becomes stuck in the lock-on (continuous spraying) position and the tank pressure needs to be relieved, carefully open the tank and place the wand inside the tank until the pressure is relieved.

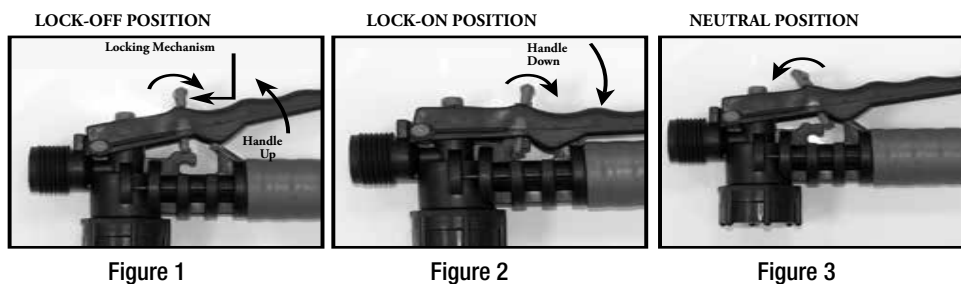

For easy pump action use the END of the pump handle. The amount of liquid delivered during spraying depends on the rate of pump stroke. The fan nozzle tip is rated at .4 gpm at 40psi. This is the nominal operating pressure of the sprayer..

## POWDER-BASED CHEMICALS

Powder-based chemicals (powder mixed with liquids to make the spraying agent) are usually abrasive and can cause wear. When you use a powder-based chemical in your sprayer, make sure it is thoroughly dissolved in the liquid solution. Thoroughly clean and flush the sprayer with water to extend the life of the sprayers parts. This sprayer is equipped with an agitator bar which facilitates mixing as the pump is operated.

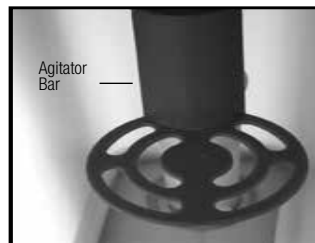

## CLEANING

- 1) Always empty the sprayer and clean the tank thoroughly after each use.
- 2) Pump the sprayer handle until all of the contents and air exit through the nozzle (minimum of 30 strokes).
- 3) Fill tank half way with water and pump the water out as explained in step 2 (repeat several times as necessary).

## Other Cleaning Hints:

- Improper spray distribution usually means the nozzle is clogged, remove the nozzle and clean it.
- Soap can be added to the water to clean the tank.
- Do not use strong cleaning agents or abrasives.
- If you use a chemical agent to clean the tank follow the manufacturer's recommendations for the disposal of the waste water.
- Follow the chemical manufacturers instructions for clean up.